

Features

- High intensity
- Wide viewing angle
- General purpose leads
- Reliable and rugged

Package Dimensions

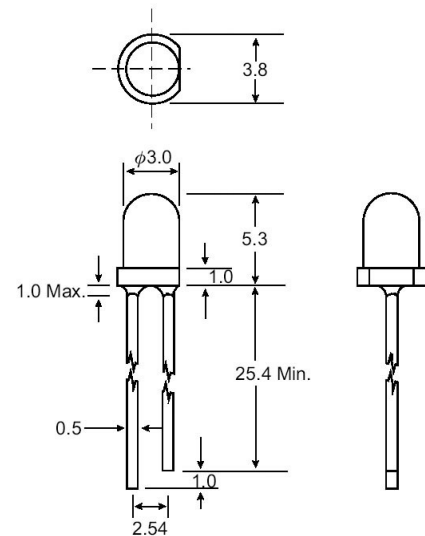

Unit: mm (inches)

Tolerance: $\pm 0.25\text{mm}$ (.010") max

Absolute Maximum Ratings at Ta=25

| Parameter | Max. | Unit |
|--|-------------------|------|
| Power Dissipation | 100 | mW |
| Peak Forward Current (1/10 Duty Cycle, 0.1ms Pulse Width) | 100 | mA |
| Continuous Forward Current | 40 | mA |
| Derating Linear From 50 | 0.4 | mA / |
| Reverse Voltage | 5 | V |
| Operating Temperature Range | -40 to +80 | |
| Storage Temperature Range | -40 to +80 | |
| Lead Soldering Temperature [4mm(.157") From Body] | 260 for 5 Seconds | |

Notes:

- All dimensions are in millimeters (inches).
- Protruded resin under flange is 1.0mm (.04") max.
- Lead spacing is measured where the leads emerge from the package.
- Viewing Angle $_{1/2}$ is the off-axis angle at which the luminous intensity is half the axial luminous intensity
- Specifications are subject to change without notice.

| Part No. | Emitting Color | Lens Color | Peak Wavelength λ_p (nm) | Operating Voltage (V) | | Output Sink Current | Output Source Current | Pulse Rate (Hz) | | Viewing Angle $2\theta_{1/2}$ (Deg) (Note 4) |
|-----------|----------------|-------------|-------------------------------------|-----------------------|-----|---------------------|-----------------------|-----------------|-----|--|
| | | | | Min | Typ | Typ (mA) | Typ (mA) | Min | Max | |
| EL-F3R651 | Ultra-Red | Diffused | 628 | 3.0 – 5.0 | | 45 | 25 | 2.0 – 2.8 | | 60 |
| EL-F3G651 | Ultra-Green | Diffused | 570 | 3.0 – 5.0 | | 45 | 25 | 2.0 – 2.8 | | 60 |
| EL-F3Y651 | Ultra-Yellow | Diffused | 590 | 3.0 – 5.0 | | 45 | 25 | 2.0 – 2.8 | | 60 |
| EL-F3O651 | Ultra-Orange | Diffused | 605 | 3.0 – 5.0 | | 45 | 25 | 2.0 – 2.8 | | 60 |
| EL-F3R252 | Ultra-Red | Water Clear | 628 | 3.0 – 5.0 | | 45 | 25 | 2.0 – 2.8 | | 18 |
| EL-F3G252 | Ultra-Green | Water Clear | 570 | 3.0 – 5.0 | | 45 | 25 | 2.0 – 2.8 | | 18 |
| EL-F3Y252 | Ultra-Yellow | Water Clear | 590 | 3.0 – 5.0 | | 45 | 25 | 2.0 – 2.8 | | 18 |
| EL-F3O252 | Ultra-Orange | Water Clear | 605 | 3.0 – 5.0 | | 45 | 25 | 2.0 – 2.8 | | 18 |
| EL-F3B252 | Ultra-Blue | Water Clear | 470 | 4.5 – 5.0 | | 45 | 25 | 2.0 – 2.8 | | 18 |

Parameter

Output Sink Current
Output Source Current
Forward Voltage
Reverse Current

Test Condition

$I_f = 20\text{mA}$
 $I_r = 20\text{mA}$
 $I_f = 20\text{mA}$
 $I_r = 20\text{mA}$