

## Features

- High intensity
- Wide viewing angle
- General purpose leads
- Reliable and rugged

## Absolute Maximum Ratings at Ta=25

Parameter	Max.	Unit
Power Dissipation	100	mW
Peak Forward Current (1/10 Duty Cycle, 0.1ms Pulse Width)	100	mA
Continuous Forward Current	40	mA
Derating Linear From 50	0.4	mA /
Reverse Voltage	5	V
Operating Temperature Range	-40 to +80	
Storage Temperature Range	-40 to +80	
Lead Soldering Temperature [4mm(.157") From Body]	260 for 5 Seconds	

### Notes:

1. All dimensions are in millimeters (inches).
2. Protruded resin under flange is 1.0mm (.04") max.
3. Lead spacing is measured where the leads emerge from the package.
4. Viewing Angle  $_{1/2}$  is the off-axis angle at which the luminous intensity is half the axial luminous intensity
5. Specifications are subject to change without notice.

## Package Dimensions

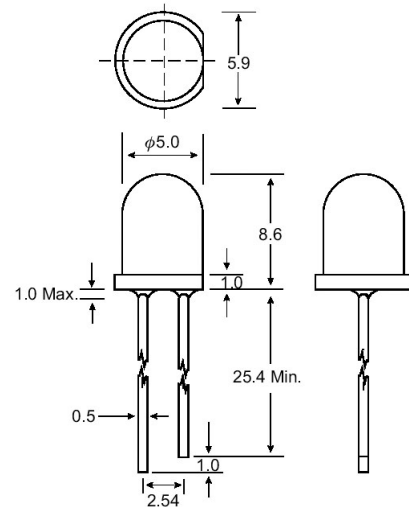

Unit: mm (inches)

Tolerance:  $\pm 0.25\text{mm}$  (.010") max

Part No.	Emitting Color	Lens Color	Peak Wavelength $\lambda_p$ (nm)	Operating Voltage (V)		Output Sink Current Typ (mA)	Output Source Current Typ (mA)	Pulse Rate (Hz)		Viewing Angle $2\theta_{1/2}$ (Deg) (Note 4)
				Min	Typ			Min	Max	
EL-F5R651	Ultra-Red	Diffused	628	3.0	5.0	45	25	2.0	2.8	60
EL-F5G651	Ultra-Green	Diffused	570	3.0	5.0	45	25	2.0	2.8	60
EL-F5Y651	Ultra-Yellow	Diffused	590	3.0	5.0	45	25	2.0	2.8	60
EL-F5O651	Ultra-Orange	Diffused	605	3.0	5.0	45	25	2.0	2.8	60
EL-F5R252	Ultra-Red	Water Clear	628	3.0	5.0	45	25	2.0	2.8	18
EL-F5G252	Ultra-Green	Water Clear	570	3.0	5.0	45	25	2.0	2.8	18
EL-F5Y252	Ultra-Yellow	Water Clear	590	3.0	5.0	45	25	2.0	2.8	18
EL-F5O252	Ultra-Orange	Water Clear	605	3.0	5.0	45	25	2.0	2.8	18
EL-F5B252	Ultra-Blue	Water Clear	470	4.5	5.0	45	25	2.0	2.8	18

### Parameter

Output Sink Current  
Output Source Current  
Forward Voltage  
Reverse Current

### Test Condition

$I_f = 20\text{mA}$   
 $I_f = 20\text{mA}$   
 $I_f = 20\text{mA}$   
 $I_r = 20\text{mA}$