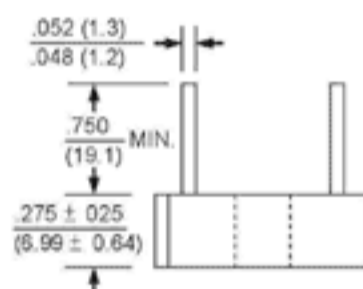
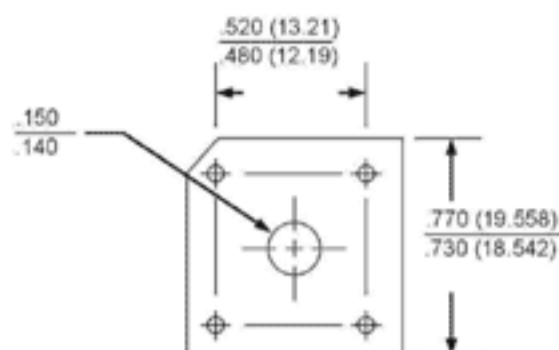

**GLASS PASSIVATED
BRIDGE RECTIFIERS**
REVERSE VOLTAGE - 50 to 1000 Volts
FORWARD CURRENT - 10.0 Amperes
FEATURES

- Surge overload rating - 170 amperes peak
- Low forward voltage drop
- Small size; simple installation
- Silver Plated Copper Leads
- Mounting Position: Any

 Polarity shown on side of case:
positive lead by beveled corner.

Dimensions in inches and (millimeters)

MAXIMUM RATINGS AND ELECTRICAL CHARACTERISTICS

Rating at 25°C ambient temperature unless otherwise specified.

Single phase, half wave, 60Hz, resistive or inductive load.

For capacitive load, derate current by 20%

CHARACTERISTICS	KBPC 1005G	KBPC 101G	KBPC 102G	KBPC 104G	KBPC 106G	KBPC 108G	KBPC 1010G	UNIT
Maximum Recurrent Peak Reverse Voltage	50	100	200	400	600	800	1000	V
Maximum RMS Bridge Input Voltage	35	70	140	280	420	560	700	V
Maximum Average Forward Rectified Output Current at T _C =50°C T _C =100°C (Note 1) T _A =50°C (Note 2)	10.0 6.0 6.0							A
Peak Forward Surge Current, 8.3ms single half sine-wave super imposed on rated load	170							A
Maximum Forward Voltage Drop per Bridge Element at 5.0A Peak	1.1							V
Maximum Reverse Current at Rated DC Blocking Voltage per Element T _A = 25°C T _A =100°C	10.0 1.0							μA mA
Operating Temperature Range T _C	-55 to +150							°C
Storage Temperature Range T _A	-55 to +150							°C

- NOTES: 1. Unit mounted on metal chassis
2. Unit mounted on P.C. board